

Brass Hexkey Extension Pipes

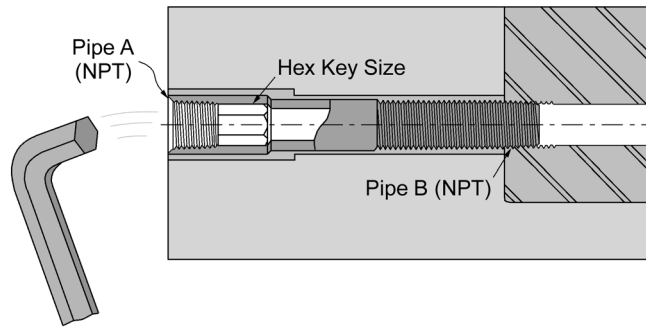
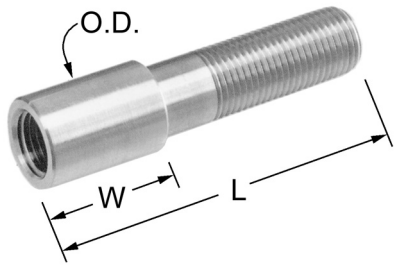

FEATURES:

- Heavy Duty Internal Hex Socket
- Hexkey Extension Pipes are Available in a Wide Variety of Special Lengths and Threads
- Accurate Length Adjustments are Easy With the Adjustable Thread System

PART NO.	PIPE SIZE "A" (NPT)	PIPE SIZE "B" (NPT)	"W"	O.D.	HEX KEY SIZE	OVERALL LENGTH "L"				
						2½"	4"	5½"	7"	8½"
EP18-__*	1/8	1/8	3/4"	1/2"	1/4"	\$3.05	\$3.60	\$4.90	\$5.70	\$6.50
EP14-__*	1/4	1/4	1"	11/16"	3/8"	\$3.40	\$3.95	\$5.20	\$6.00	\$6.85
EP38-__*	3/8	3/8	1¼"	13/16"	1/2"	\$3.80	\$4.45	\$6.15	\$8.00	\$9.05
EP50-__*	1/2	1/2	1½"	1"	9/16"	\$6.50	\$7.25	\$8.75	\$10.30	\$11.60

*To order, insert desired overall length; Example: EP14-212

Piston Tubes

FEATURES:

- *Stainless Steel Tubes*
- Precision Brazed Assembly Provides High Strength and Reliable Performance
- Coolant Flows Through Hex Socket and High Flow Stainless Tube
- High-Flow Stainless Tube Provides Maximum Cooling Rates

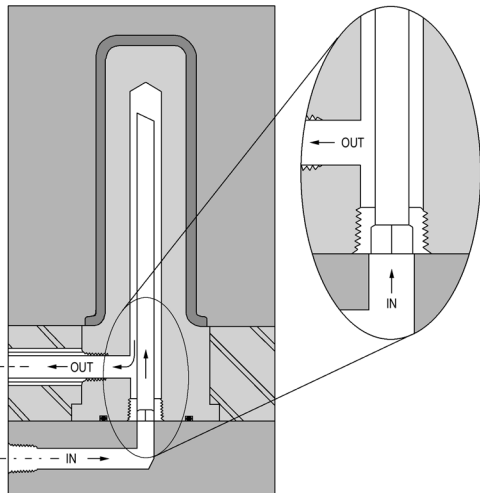
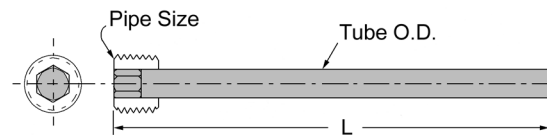
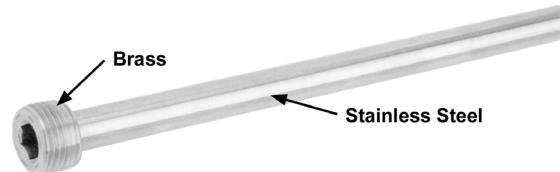

PART NO.	PIPE SIZE (NPT)	TUBE O.D.	TUBE I.D.	OVERALL LENGTH "L"			
				12"	24"	36"	48"
PT16-__B*	1/16	.125"	.109"	\$8.45	\$9.65	\$10.85	\$12.05
PT18-__B*	1/8	.187"	.167"	\$8.45	\$9.65	\$10.85	\$12.05
PT14-__B*	1/4	.250"	.230"	\$8.95	\$10.15	\$11.35	\$12.55
PT38-__B*	3/8	.375"	.345"	\$9.25	\$10.45	\$11.65	\$12.85
PT12-__B*	1/2	.375"	.345"	\$9.65	\$10.85	\$12.05	\$13.25
PT34-__B*	3/4	.437"	.407"	\$15.40	\$16.50	\$17.50	\$18.50

*To order, insert desired overall length; Example: PT14-24B

Pipe plug also available in steel or stainless steel.