

Quick-Coupler Type Water Jumpers

FEATURES:

- For Use With Push-Lock Hose, No Hose Clamps Required
- Coupler Sleeve Twists to Lock Preventing Accidental Disconnect
- Oversized and Unrestricted Flow Path Maintains **Full Flow Rate** of Hose Used
- Eliminates Bulky Hose Loops
- Compact Design Neatly and Safely Holds Cooling Lines Close to the Mold Surface
- Stock Only One Part Number for Any Hose Size — No Special Tubes or Length Restrictions
- Compatible with All Major Mold Connection Systems
- Unlimited Installation Options — Fits Around Obstacles and Installs in Compact Spaces
- Viton Seals Provide for Temperatures Up To 400°F
- All Brass and Stainless Steel Construction

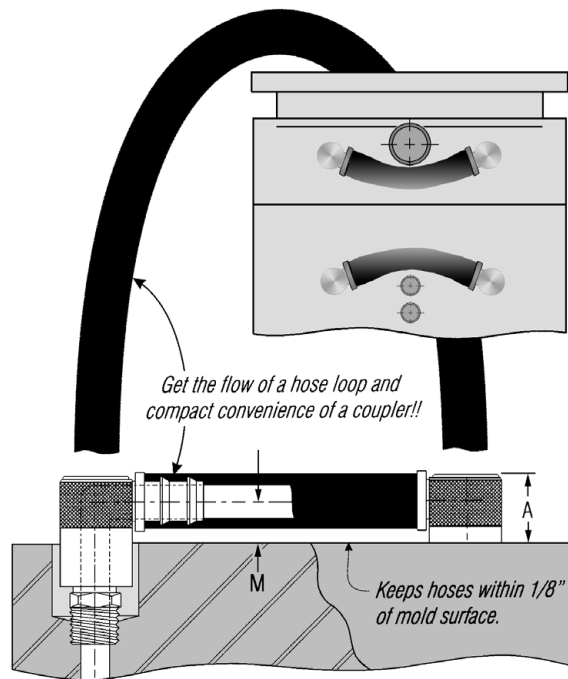
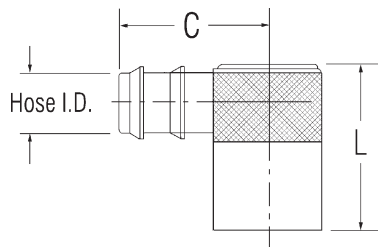

PART NO.	FITS PLUG SERIES NO.	HOSE I.D.	"L"	"C"	"M"	"A"	PRICE EACH
WJ200-4	200	1/4"	1"	1-1/4"	3/8"	5/8"	\$6.30
WJ200-5	200	5/16"	1"	1-1/4"	3/8"	5/8"	\$6.30
WJ200-6	200	3/8"	1"	1-1/4"	3/8"	5/8"	\$6.30
WJ300-6	300	3/8"	1-7/16"	1-9/16"	1/2"	7/8"	\$7.40
WJ300-8	300	1/2"	1-7/16"	1-9/16"	1/2"	7/8"	\$7.40
WJ500-8	500	1/2"	2-1/8"	2"	7/8"	1-5/16"	\$11.70
WJ500-12	500	3/4"	2-1/8"	2"	7/8"	1-5/16"	\$11.70

Water Quick Connect Couplings

DESCRIPTION:

Moldtite Couplings are specially designed for connecting coolant lines to molds and dies. Couplers and plugs are available in non-valved straight-thru and valved shut-off designs, with standard or push-lock hose barsbs.

For maximum unrestricted flow, we recommend the non-valved straight-thru coupler and non-valved straight-thru plug combination.

Where loss of fluid in the mold or die (when disconnected) is of prime concern, a valved shut-off coupler with a valved shut-off plug is recommended. When the increase in flow is more important than the loss of fluid, the valved shut-off coupler can be connected with a non-valved straight-thru plug. However, a valved shut-off plug cannot be used without a valved shut-off coupler.

Push-lock couplers should be used with push-lock hose, eliminating the need for hose clamps.

STANDARD DESIGN:

- Coupler Body: Brass
- Sleeve: Brass
- Sleeve for Valved Coupler: Nickel-plated
- Valve: Brass
- Plugs: Brass
- Seals - Series 200 & 300: Silicone (-80°F to +400°F)
- Seals - Series 500: Viton (-15°F to +400°F)

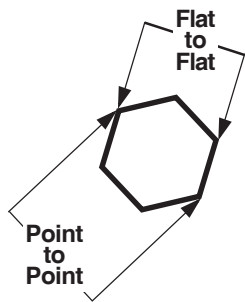

TEMPERATURE: -40°F to +500°F
MAXIMUM RATED PRESSURE: 1000 psi

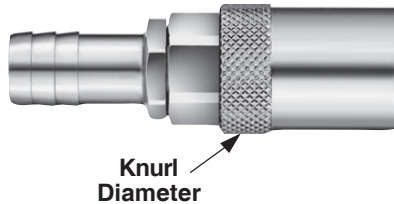

DIMENSIONS			
SERIES #	FLAT TO FLAT	POINT TO POINT	KNURL DIAMETER
200 SERIES	0.588 (19/32")	0.627	0.695
300 SERIES	0.746 (3/4")	0.826	0.905
500 SERIES	1.103 (1-1/8")	1.265	1.186



200 SERIES

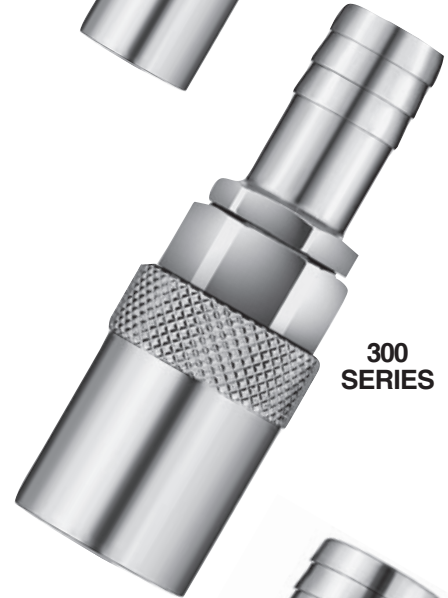

300 SERIES

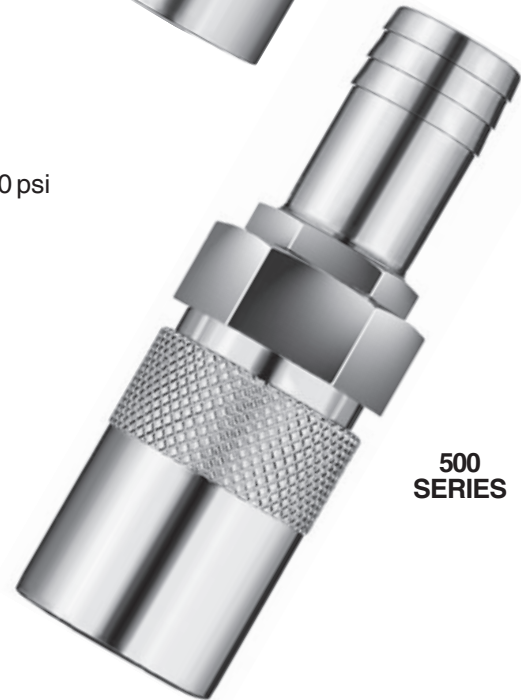

500 SERIES

Replacement seals are available in SILICONE for water and glycol; or VITON for oil-heat transfer.



REPLACEMENT SILICONE SEALS		
PART NO.	PRICE PER	
	DOZEN	100
PSE-200-12	\$1.50	--
PSE-200-100	--	\$11.25
PSE-300-12	\$2.00	--
PSE-300-100	--	\$15.00

REPLACEMENT VITON SEALS	
PART NO.	PRICE PER DOZEN
PSE-200-12VT	\$10.50
PSE-300-12VT	\$11.80
PSE-500-12VT	\$18.00

Water Quick Connect Couplings...continued

Moldtite Couplings are interchangeable with the DME "Jiffy-Tite" and "Jiffy-Matic", Foster "FJT" and Parker "Moldmate" types.

Valved, Shut-Off Plugs

Must be used with Valved Coupler

PART DESCRIPTION	PART NO.	PIPE THREAD (NPT)	PLUG I.D.	PRICE EACH		
				1-99	100-499	500+
MALE THREAD BRASS	PSE-252SV	1/4	1/4"	\$2.58	\$2.49	\$2.33
	PSE-353SV	3/8	3/8"	\$4.74	\$4.58	\$4.27
	PSE-354SV	1/2	3/8"	\$5.03	\$4.86	\$4.53

Valved, Shut-Off Couplers 

May be used with either Valved or Non-Valved Plugs

PART DESCRIPTION	PART NO.	FITS HOSE I.D.	SOCKET WATER PASSAGE	PRICE EACH			USE WITH PLUG NUMBER	
				1-99	100-499	500+		
STRAIGHT BARB 	PSE-200V*	1/8 NPT	1/4"	\$3.60	\$3.47	\$3.24	PSE-250, PSE-251, PSE-252, PSE-253, PSE-250F, PSE-251F, PSE-252F, PSE-253F or PSE-252SV	
	PSE-204V	1/4"	1/4"	\$4.85	\$4.69	\$4.37		
	PSE-206V	3/8"	1/4"	\$4.85	\$4.69	\$4.37		
	PSE-300V*	1/4 NPT	3/8"	3/8"	\$6.92	\$6.68	\$6.23	PSE-351, PSE-352, PSE-353, PSE-354, PSE-351F, PSE-352F, PSE-353F, PSE-354F, PSE-353SV or PSE-354SV
	PSE-306V	3/8"	3/8"	\$6.84	\$6.60	\$6.17		
	PSE-308V	1/2"	3/8"	\$6.84	\$6.60	\$6.17		
	PSE-500V*	1/2 NPT	1/2"	1/2"	\$12.05	\$11.63	\$10.85	PSE-552, PSE-553, PSE-554, PSE-556, PSE-552F, PSE-553F, PSE-554F or PSE-556F
	PSE-504V	1/2"	1/2"	\$16.59	\$16.02	\$14.93		
PSE-506V	3/4"	1/2"	\$17.10	\$16.41	\$15.39			
45° BARB 	PSE-224V	1/4"	1/4"	\$5.70	\$5.51	\$5.13	PSE-250, PSE-251, PSE-252, PSE-253, PSE-250F, PSE-251F, PSE-252F, PSE-253F or PSE-252SV	
	PSE-225V	5/16"	1/4"	\$5.70	\$5.51	\$5.13		
	PSE-226V	3/8"	1/4"	\$5.70	\$5.51	\$5.13		
	PSE-326V	3/8"	3/8"	\$8.24	\$7.95	\$7.42	PSE-351, PSE-352, PSE-353, PSE-354, PSE-351F, PSE-352F, PSE-353F, PSE-354F, PSE-252SV, PSE-353SV or PSE-354SV	
	PSE-328V	1/2"	3/8"	\$8.24	\$7.95	\$7.42		
90° BARB 	PSE-214V	1/4"	1/4"	\$5.66	\$5.46	\$5.10	PSE-250, PSE-251, PSE-252, PSE-253, PSE-250F, PSE-251F, PSE-252F, PSE-253F or PSE-252SV	
	PSE-215V	5/16"	1/4"	\$5.66	\$5.46	\$5.10		
	PSE-216V	3/8"	1/4"	\$5.66	\$5.46	\$5.10		
	PSE-316V	3/8"	3/8"	\$8.24	\$7.95	\$7.42	PSE-351, PSE-352, PSE-353, PSE-354, PSE-351F, PSE-352F, PSE-353F, PSE-354F, PSE-353SV or PSE-354SV	
	PSE-318V	1/2"	3/8"	\$8.24	\$7.95	\$7.42		

* Without Hose Barb

Plug Size Templates

200 SERIES

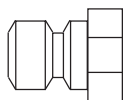

300 SERIES

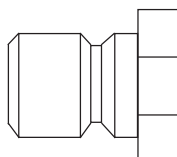

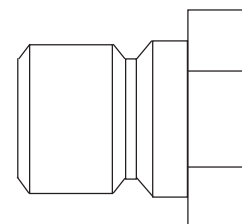

500 SERIES

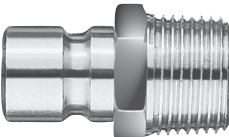

Water Quick Connect Couplings...continued

Non-Valved, Straight-Thru Plugs 

PART DESCRIPTION	PART NO.	PIPE THREAD (NPT)	PLUG I.D.	PRICE EACH		
				1-99	100-499	500+
MALE THREAD BRASS 	PSE-250	1/16	1/4"	\$1.05	\$1.00	\$0.95
	PSE-251	1/8	1/4"	\$0.38	\$0.36	\$0.34
	PSE-252	1/4	1/4"	\$0.46	\$0.45	\$0.42
	PSE-253	3/8	1/4"	\$0.70	\$0.67	\$0.63
	PSE-351	1/8	3/8"	\$0.83	\$0.80	\$0.75
	PSE-352	1/4	3/8"	\$0.62	\$0.60	\$0.56
	PSE-353	3/8	3/8"	\$0.73	\$0.70	\$0.66
	PSE-354	1/2	3/8"	\$1.81	\$1.75	\$1.63
	PSE-552	1/4	1/2"	\$2.10	\$2.00	\$1.89
	PSE-553	3/8	1/2"	\$2.10	\$2.00	\$1.89
	PSE-554	1/2	1/2"	\$2.15	\$2.10	\$1.93
	PSE-556	3/4	1/2"	\$3.22	\$3.15	\$2.90
FEMALE THREAD BRASS 	PSE-250F	1/16	1/4"	\$1.02	\$0.98	\$0.92
	PSE-251F	1/8	1/4"	\$0.64	\$0.62	\$0.58
	PSE-252F	1/4	1/4"	\$0.64	\$0.62	\$0.58
	PSE-253F	3/8	1/4"	\$1.36	\$1.32	\$1.22
	PSE-351F	1/8	3/8"	\$0.90	\$0.87	\$0.81
	PSE-352F	1/4	3/8"	\$0.67	\$0.64	\$0.60
	PSE-353F	3/8	3/8"	\$1.35	\$1.30	\$1.22
	PSE-354F	1/2	3/8"	\$1.97	\$1.92	\$1.82
	PSE-551F	1/8	1/2"	\$2.03	\$1.96	\$1.83
	PSE-552F	1/4	1/2"	\$2.03	\$1.96	\$1.83
	PSE-553F	3/8	1/2"	\$2.03	\$1.96	\$1.83
	PSE-554F	1/2	1/2"	\$2.60	\$2.54	\$2.34
FEMALE THREAD STEEL 	PSE-251FS	1/8	1/4"	\$0.91	\$0.88	\$0.82
	PSE-252FS	1/4	1/4"	\$0.87	\$0.83	\$0.72
	PSE-253FS	3/8	1/4"	\$1.12	\$1.07	\$0.95
	PSE-352FS	1/4	3/8"	\$0.90	\$0.87	\$0.79
	PSE-353FS	3/8	3/8"	\$1.10	\$1.05	\$0.95
	PSE-354FS	1/2	3/8"	\$2.43	\$2.38	\$2.30
	PSE-554FS	1/2	1/2"	\$2.82	\$2.72	\$2.54
	PSE-556FS	3/4	1/2"	\$4.81	\$4.64	\$4.33

Pipe Thread Size Templates

(For Proper Size Selection: NPT actual measurement is approximately 1/4" larger than NPT size.)



1/16
NPT



1/8
NPT



1/4
NPT



3/8
NPT



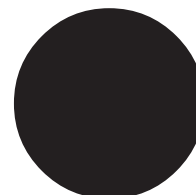

1/2
NPT



3/4
NPT

Water Quick Connect Couplings...continued

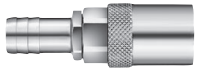
Non-Valved, Straight-Thru Couplers

PART DESCRIPTION	PART NO.	FITS HOSE I.D.	SOCKET WATER PASSAGE	PRICE EACH			USE WITH PLUG NUMBER
				1-99	100-499	500+	
	PSE-200*	1/8 NPT	1/4"	\$2.99	\$2.89	\$2.69	PSE-250, PSE-251, PSE-252, PSE-253, PSE-250F, PSE-251F, PSE-252F, or PSE-253F
	PSE-204	1/4"	1/4"	\$3.09	\$2.98	\$2.78	
	PSE-205	5/16"	1/4"	\$3.17	\$3.06	\$2.85	
	PSE-206	3/8"	1/4"	\$3.09	\$2.98	\$2.78	
	PSE-300*	1/4 NPT	3/8"	\$3.45	\$3.33	\$3.11	PSE-351, PSE-352, PSE-353, PSE-354, PSE-351F, PSE-352F, PSE-353F, or PSE-354F
	PSE-306	3/8"	3/8"	\$4.15	\$4.01	\$3.74	
	PSE-308	1/2"	3/8"	\$4.15	\$4.01	\$3.74	
	PSE-500*	1/2 NPT	1/2"	\$7.25	\$7.00	\$6.55	PSE-552, PSE-553, PSE-554, PSE-556, PSE-552F, PSE-553F, PSE-554F, or PSE-556F
	PSE-504	1/2"	1/2"	\$10.98	\$10.60	\$9.88	
	PSE-506	3/4"	1/2"	\$11.48	\$11.09	\$10.33	
	PSE-224	1/4"	1/4"	\$4.43	\$4.29	\$3.99	PSE-250, PSE-251, PSE-252, PSE-253, PSE-250F, PSE-251F, PSE-252F, or PSE-253F
	PSE-225	5/16"	1/4"	\$4.43	\$4.29	\$3.99	
	PSE-226	3/8"	1/4"	\$4.43	\$4.29	\$3.99	
	PSE-326	3/8"	3/8"	\$5.78	\$5.59	\$5.20	PSE-351, PSE-352, PSE-353, PSE-354, PSE-351F, PSE-352F, PSE-353F, or PSE-354F
	PSE-328	1/2"	3/8"	\$5.83	\$5.63	\$5.25	
	PSE-214	1/4"	1/4"	\$4.43	\$4.29	\$3.99	PSE-250, PSE-251, PSE-252, PSE-253, PSE-250F, PSE-251F, PSE-252F, or PSE-253F
	PSE-215	5/16"	1/4"	\$4.43	\$4.29	\$3.99	
	PSE-216	3/8"	1/4"	\$4.43	\$4.29	\$3.99	
	PSE-316	3/8"	3/8"	\$4.79	\$4.62	\$4.31	PSE-351, PSE-352, PSE-353, PSE-354, PSE-351F, PSE-352F, PSE-353F, or PSE-354F
	PSE-318	1/2"	3/8"	\$5.83	\$5.63	\$5.25	
	PSE-514	1/2"	1/2"	\$16.00	\$15.45	\$14.40	PSE-552, PSE-553, PSE-554, PSE-556, PSE-552F, PSE-553F, PSE-554F, or PSE-556F
	PSE-516	3/4"	1/2"	\$16.13	\$15.58	\$14.52	

*Without Hose Barb

Non-Valved, Straight-Thru Push-Lock Couplers

PART DESCRIPTION	PART NO.	FITS HOSE I.D.	SOCKET WATER PASSAGE	PRICE EACH			USE WITH PLUG NUMBER
				1-99	100-499	500+	
	PSE-204PL	1/4"	1/4"	\$3.38	\$3.26	\$3.04	PSE-250, PSE-251, PSE-252, PSE-253, PSE-250F, PSE-251F, PSE-252F, or PSE-253F
	PSE-206PL	3/8"	1/4"	\$3.46	\$3.35	\$3.12	
	PSE-306PL	3/8"	3/8"	\$4.52	\$4.37	\$4.07	PSE-351, PSE-352, PSE-353, PSE-354, PSE-351F, PSE-352F, PSE-353F, or PSE-354F
	PSE-308PL	1/2"	3/8"	\$4.61	\$4.45	\$4.15	
	PSE-224PL	1/4"	1/4"	\$4.65	\$4.49	\$4.19	PSE-250, PSE-251, PSE-252, PSE-253, PSE-250F, PSE-251F, PSE-252F, or PSE-253F
	PSE-226PL	3/8"	1/4"	\$4.69	\$4.53	\$4.22	
	PSE-326PL	3/8"	3/8"	\$5.29	\$5.11	\$4.76	
	PSE-328PL	1/2"	3/8"	\$6.46	\$6.24	\$5.82	PSE-351, PSE-352, PSE-353, PSE-354, PSE-351F, PSE-352F, PSE-353F, or PSE-354F
	PSE-214PL	1/4"	1/4"	\$4.65	\$4.49	\$4.19	PSE-250, PSE-251, PSE-252, PSE-253, PSE-250F, PSE-251F, PSE-252F, or PSE-253F
	PSE-216PL	3/8"	1/4"	\$4.69	\$4.53	\$4.22	
	PSE-316PL	3/8"	3/8"	\$6.25	\$6.03	\$5.63	
	PSE-318PL	1/2"	3/8"	\$6.33	\$6.12	\$5.70	PSE-351, PSE-352, PSE-353, PSE-354, PSE-351F, PSE-352F, PSE-353F, or PSE-354F

Water/Hydraulic Non-Valved Brass Quick Couplers

EXCELLENT FOR USE ON MANIFOLD MAIN LINE CONNECTIONS!

Interchangeable with Parker ST, Foster FST, Perfecting E, Hansen & Anflo CST

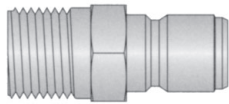

MALE PLUG

PART NO.	NPT THREAD SIZE	PRICE EACH
MP-12	3/4	\$4.30
MP-16	1	\$10.00
MP-20	1¼	\$23.95
MP-24	1½	\$33.95
MP-36	2	\$46.55

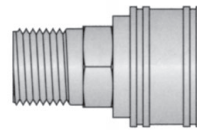

MALE SOCKET

PART NO.	NPT THREAD SIZE	PRICE EACH
MS-12	3/4	\$10.90
MS-16	1	\$16.20
MS-20	1 ¼	\$43.15
MS-24	1 ½	\$59.10
MS-36	2	\$81.50

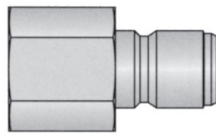

FEMALE PLUG

PART NO.	NPT THREAD SIZE	PRICE EACH
FP-12	3/4	\$4.30
FP-16	1	\$9.15
FP-20	1¼	\$20.90
FP-24	1½	\$33.95
FP-36	2	\$46.15

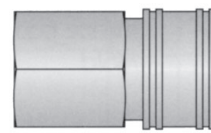

FEMALE SOCKET

PART NO.	NPT THREAD SIZE	PRICE EACH
FS-12	3/4	\$10.90
FS-16	1	\$13.70
FS-20	1¼	\$43.15
FS-24	1½	\$59.10
FS-36	2	\$81.45

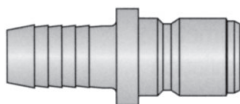

HOSE PLUG

For Use With Hose Clamps

PART NO.	HOSE I.D.	PRICE EACH
HP-12*	3/4"	\$6.05
HP-16*	1"	\$13.05

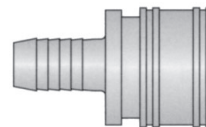

HOSE SOCKET

For Use With Hose Clamps

PART NO.	HOSE I.D.	PRICE EACH
HS-12*	3/4"	\$13.05
HS-16*	1"	\$17.85

Valved Brass Shut-off Couplers

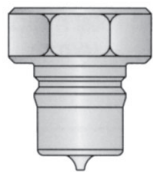

PART NO.	NPT THREAD SIZE	PRICE EACH
HP3434B	3/4	\$13.90
HP11B	1	\$18.75
HP114114B	1¼	\$103.95
HP112112B	1½	\$129.65

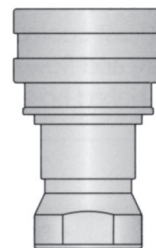

PART NO.	NPT THREAD SIZE	PRICE EACH
HC3434B	3/4	\$34.05
HC11B	1	\$41.20
HC114114B	1¼	\$139.30
HC112112B	1½	\$169.65

CAUTION: SHUT-OFF REDUCES FLOW