

Quick-Coupler Type Water Jumpers

FEATURES:

- For Use With Push-Lock Hose, No Hose Clamps Required
- Coupler Sleeve Twists to Lock Preventing Accidental Disconnect
- Oversized and Unrestricted Flow Path Maintains **Full Flow Rate** of Hose Used
- Eliminates Bulky Hose Loops
- Compact Design Neatly and Safely Holds Cooling Lines Close to the Mold Surface
- Stock Only One Part Number for Any Hose Size — No Special Tubes or Length Restrictions
- Compatible with All Major Mold Connection Systems
- Unlimited Installation Options — Fits Around Obstacles and Installs in Compact Spaces
- Viton Seals Provide for Temperatures Up To 400°F
- All Brass and Stainless Steel Construction

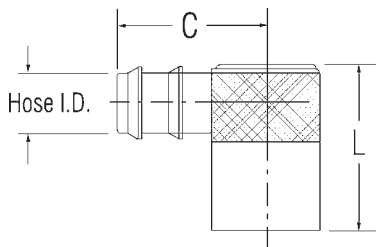
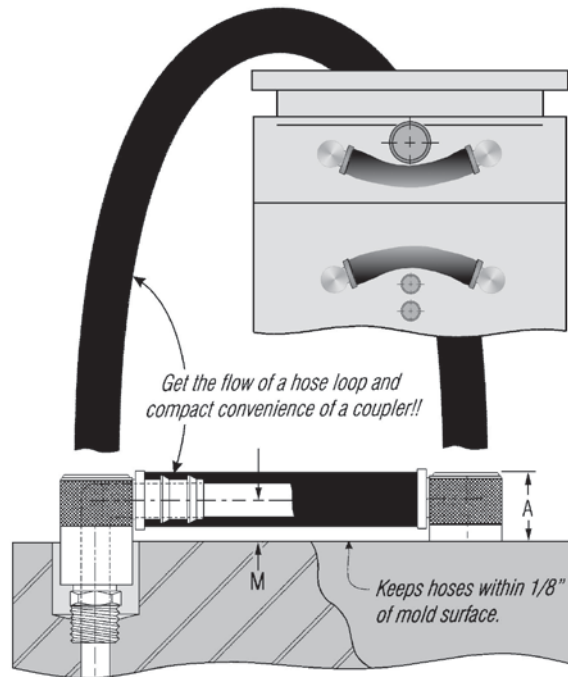

PART NO.	FITS PLUG SERIES NO.	HOSE I.D.	"L"	"C"	"M"	"A"	PRICE EACH
WJ200-4	200	1/4"	1"	1-1/4"	3/8"	5/8"	Call for Pricing
WJ200-5	200	5/16"	1"	1-1/4"	3/8"	5/8"	
WJ200-6	200	3/8"	1"	1-1/4"	3/8"	5/8"	
WJ300-6	300	3/8"	1-7/16"	1-9/16"	1/2"	7/8"	
WJ300-8	300	1/2"	1-7/16"	1-9/16"	1/2"	7/8"	
WJ500-8	500	1/2"	2-1/8"	2"	7/8"	1-5/16"	
WJ500-12	500	3/4"	2-1/8"	2"	7/8"	1-5/16"	

Water Quick Connect Couplings

DESCRIPTION:

Moldtite Couplings are specially designed for connecting coolant lines to molds and dies. Couplers and plugs are available in non-valved straight-thru and valved shut-off designs, with standard or push-lock hose barsbs.

For maximum unrestricted flow, we recommend the non-valved straight-thru coupler and non-valved straight-thru plug combination.

Where loss of fluid in the mold or die (when disconnected) is of prime concern, a valved shut-off coupler with a valved shut-off plug is recommended. When the increase in flow is more important than the loss of fluid, the valved shut-off coupler can be connected with a non-valved straight-thru plug. However, a valved shut-off plug cannot be used without a valved shut-off coupler.

Push-lock couplers should be used with push-lock hose, eliminating the need for hose clamps.

STANDARD DESIGN:

- Coupler Body: Brass
- Sleeve: Brass
- Sleeve for Valved Coupler: Nickel-plated
- Valve: Brass
- Plugs: Brass
- Seals - Series 200 & 300: Silicone (-80°F to +400°F)
- Seals - Series 500: Viton (-15°F to +400°F)

TEMPERATURE: -40°F to +500°F
MAXIMUM RATED PRESSURE: 1000 psi

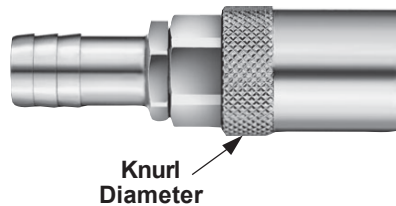
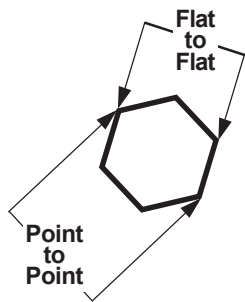

DIMENSIONS			
SERIES #	FLAT TO FLAT	POINT TO POINT	KNURL DIAMETER
200 SERIES	0.588 (19/32")	0.627	0.695
300 SERIES	0.746 (3/4")	0.826	0.905
500 SERIES	1.103 (1-1/8")	1.265	1.186

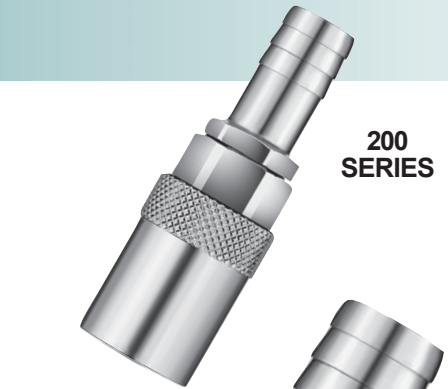

200 SERIES

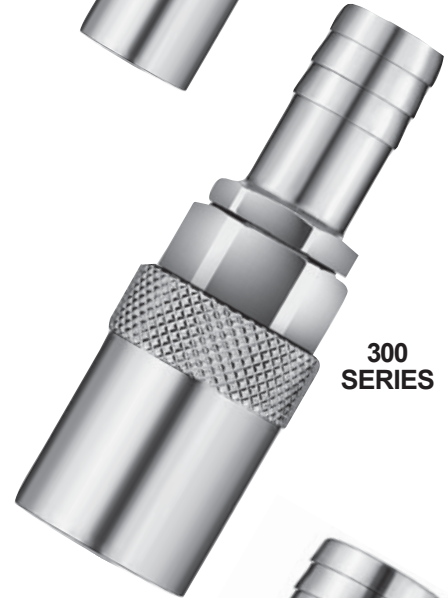

300 SERIES

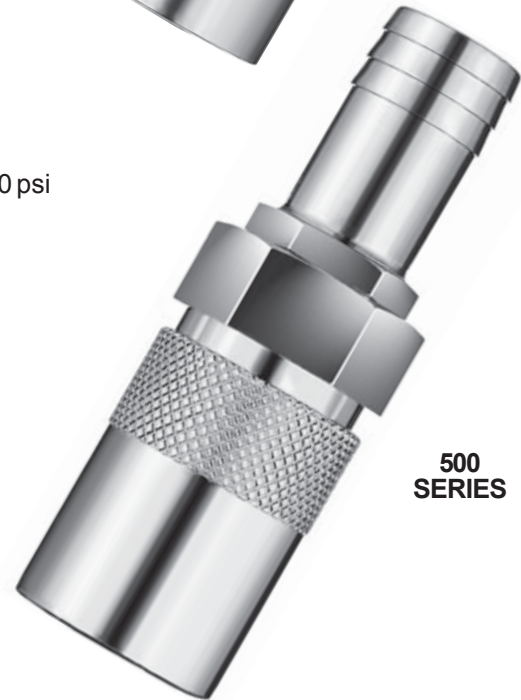

500 SERIES

Replacement seals are available in **SILICONE** for water and glycol; or **VITON** for oil-heat transfer.

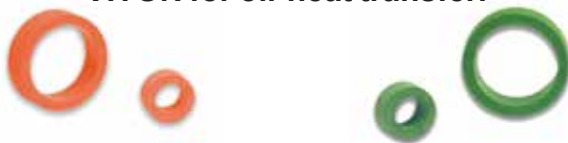

REPLACEMENT SILICONE SEALS		
PART NO.	PRICE PER	
	DOZEN	100
PSE-200-12	Call for Pricing 800-627-1033	
PSE-200-100		
PSE-300-12		
PSE-300-100		

REPLACEMENT VITON SEALS	
PART NO.	PRICE PER DOZEN
PSE-200-12VT	Call for Pricing
PSE-300-12VT	
PSE-500-12VT	

Water Quick Connect Couplings...continued

Moldtite Couplings are interchangeable with the DME "Jiffy-Tite" and "Jiffy-Matic", Foster "FJT" and Parker "Moldmate" types.

Valved, Shut-Off Plugs



Must be used with Valved Coupler

-PART DESCRIPTION	PART NO.	PIPE THREAD (NPT)	PLUG I.D.	PRICE EACH	
				1-99	100+
MALE THREAD BRASS	PSE-252SV	1/4	1/4"	Call for Pricing	
	PSE-353SV	3/8	3/8"		

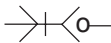
Valved, Shut-Off Couplers



May be used with either Valved or Non-Valved Plugs

PART DESCRIPTION	PART NO.	FITS HOSE I.D.	SOCKET WATER PASSAGE	PRICE EACH		USE WITH PLUG NUMBER
				1-99	100+	
STRAIGHT BARB 	PSE-200V*	1/8 NPT	1/4"	Call for Pricing 800-627-1033		PSE-250, PSE-251, PSE-252, PSE-253, PSE-250F, PSE-251F, PSE-252F, PSE-253F or PSE-252SV
	PSE-204V	1/4"	1/4"			
	PSE-206V	3/8"	1/4"			
	PSE-300V*	1/4 NPT	3/8"			
	PSE-306V	3/8"	3/8"			
	PSE-308V	1/2"	3/8"			
	PSE-500V*	1/2 NPT	1/2"			
	PSE-504V	1/2"	1/2"			
45° BARB 	PSE-224V	1/4"	1/4"	Call for Pricing 800-627-1033		PSE-250, PSE-251, PSE-252, PSE-253, PSE-250F, PSE-251F, PSE-252F, PSE-253F or PSE-252SV
	PSE-225V	5/16"	1/4"			
	PSE-226V	3/8"	1/4"			
	PSE-326V	3/8"	3/8"			
	PSE-328V	1/2"	3/8"			
90° BARB 	PSE-214V	1/4"	1/4"	Call for Pricing 800-627-1033		PSE-250, PSE-251, PSE-252, PSE-253, PSE-250F, PSE-251F, PSE-252F, PSE-253F or PSE-252SV
	PSE-215V	5/16"	1/4"			
	PSE-216V	3/8"	1/4"			
	PSE-316V	3/8"	3/8"			
	PSE-318V	1/2"	3/8"			

* Without Hose Barb

Plug Size Templates

200 SERIES

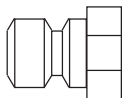

300 SERIES

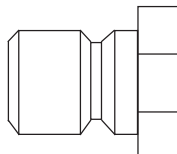

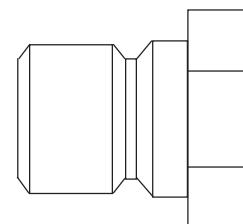

500 SERIES

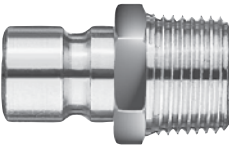

Water Quick Connect Couplings...continued

Non-Valved, Straight-Thru Plugs

PART DESCRIPTION	PART NO.	PIPE THREAD (NPT)	PLUG I.D.	PRICE EACH	
				1-99	100+
MALE THREAD BRASS 	PSE-250	1/16	1/4"	Call for Pricing 800-627-1033	
	PSE-251	1/8	1/4"		
	PSE-252	1/4	1/4"		
	PSE-253	3/8	1/4"		
	PSE-351	1/8	3/8"		
	PSE-352	1/4	3/8"		
	PSE-353	3/8	3/8"		
	PSE-354	1/2	3/8"		
	PSE-552	1/4	1/2"		
	PSE-553	3/8	1/2"		
	PSE-554	1/2	1/2"		
	PSE-556	3/4	1/2"		
FEMALE THREAD BRASS 	PSE-250F	1/16	1/4"		
	PSE-251F	1/8	1/4"		
	PSE-252F	1/4	1/4"		
	PSE-253F	3/8	1/4"		
	PSE-351F	1/8	3/8"		
	PSE-352F	1/4	3/8"		
	PSE-353F	3/8	3/8"		
	PSE-354F	1/2	3/8"		
	PSE-551F	1/8	1/2"		
	PSE-552F	1/4	1/2"		
	PSE-553F	3/8	1/2"		
	PSE-554F	1/2	1/2"		
FEMALE THREAD STEEL 	PSE-251FS	1/8	1/4"		
	PSE-252FS	1/4	1/4"		
	PSE-253FS	3/8	1/4"		
	PSE-352FS	1/4	3/8"		
	PSE-353FS	3/8	3/8"		
	PSE-354FS	1/2	3/8"		
	PSE-554FS	1/2	1/2"		
	PSE-556FS	3/4	1/2"		

Pipe Thread Size Templates

(For Proper Size Selection: NPT actual measurement is approximately 1/4" larger than NPT size.)



1/16
NPT



1/8
NPT



1/4
NPT



3/8
NPT

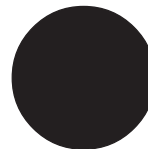

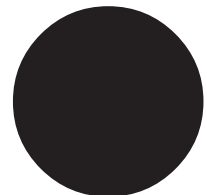

1/2
NPT



3/4
NPT

Water Quick Connect Couplings...continued

Non-Valved, Straight-Thru Couplers

PART DESCRIPTION	PART NO.	FITS HOSE I.D.	SOCKET WATER PASSAGE	PRICE EACH		USE WITH PLUG NUMBER
				1-99	100+	
STRAIGHT BARB 	PSE-200*	1/8 NPT	1/4"	Call for Pricing 800-627-1033		PSE-250, PSE-251, PSE-252, PSE-253, PSE-250F, PSE-251F, PSE-252F, or PSE-253F
	PSE-204	1/4"	1/4"			
	PSE-205	5/16"	1/4"			
	PSE-206	3/8"	1/4"			PSE-351, PSE-352, PSE-353, PSE-354, PSE-351F, PSE-352F, PSE-353F, or PSE-354F
	PSE-300*	1/4 NPT	3/8"			
	PSE-306	3/8"	3/8"			
	PSE-308	1/2"	3/8"			PSE-552, PSE-553, PSE-554, PSE-556, PSE-552F, PSE-553F, PSE-554F, or PSE-556F
	PSE-500*	1/2 NPT	1/2"			
	PSE-504	1/2"	1/2"			
PSE-506	3/4"	1/2"	PSE-250, PSE-251, PSE-252, PSE-253, PSE-250F, PSE-251F, PSE-252F, or PSE-253F			
45° BARB 	PSE-224	1/4"				1/4"
	PSE-225	5/16"				1/4"
	PSE-226	3/8"	1/4"			
90° BARB 	PSE-326	3/8"	3/8"			PSE-351, PSE-352, PSE-353, PSE-354, PSE-351F, PSE-352F, PSE-353F, or PSE-354F
	PSE-328	1/2"	3/8"			
	PSE-214	1/4"	1/4"			
	PSE-215	5/16"	1/4"			
	PSE-216	3/8"	1/4"			
		PSE-316	3/8"	3/8"	PSE-351, PSE-352, PSE-353, PSE-354, PSE-351F, PSE-352F, PSE-353F, or PSE-354F	
PSE-318		1/2"	3/8"			
PSE-514		1/2"	1/2"	PSE-552, PSE-553, PSE-554, PSE-556, PSE-552F, PSE-553F, PSE-554F, or PSE-556F		
PSE-516		3/4"	1/2"			

*Without Hose Barb

Non-Valved, Straight-Thru Push-Lock Couplers

PART DESCRIPTION	PART NO.	FITS HOSE I.D.	SOCKET WATER PASSAGE	PRICE EACH		USE WITH PLUG NUMBER
				1-99	100+	
STRAIGHT BARB 	PSE-204PL	1/4"	1/4"	Call for Pricing 800-627-1033		PSE-250, PSE-251, PSE-252, PSE-253, PSE-250F, PSE-251F, PSE-252F, or PSE-253F
	PSE-206PL	3/8"	1/4"			
	PSE-306PL	3/8"	3/8"			PSE-351, PSE-352, PSE-353, PSE-354, PSE-351F, PSE-352F, PSE-353F, or PSE-354F
	PSE-308PL	1/2"	3/8"			
45° BARB 	PSE-224PL	1/4"	1/4"			PSE-250, PSE-251, PSE-252, PSE-253, PSE-250F, PSE-251F, PSE-252F, or PSE-253F
	PSE-226PL	3/8"	1/4"			
	PSE-326PL	3/8"	3/8"			
	PSE-328PL	1/2"	3/8"			
90° BARB 	PSE-214PL	1/4"	1/4"			PSE-250, PSE-251, PSE-252, PSE-253, PSE-250F, PSE-251F, PSE-252F, or PSE-253F
	PSE-216PL	3/8"	1/4"			
	PSE-316PL	3/8"	3/8"			PSE-351, PSE-352, PSE-353, PSE-354, PSE-351F, PSE-352F, PSE-353F, or PSE-354F
	PSE-318PL	1/2"	3/8"			

Water/Hydraulic Non-Valved Brass Quick Couplers

EXCELLENT FOR USE ON MANIFOLD MAIN LINE CONNECTIONS!

Interchangeable with Parker ST, Foster FST, Perfecting E, Hansen & Anflo CST



MALE PLUG

PART NO.	NPT THREAD SIZE	PRICE EACH
MP-12	3/4	Call for Pricing
MP-16	1	
MP-20	1¼	
MP-24	1½	
MP-36	2	

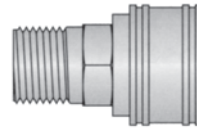

MALE SOCKET

PART NO.	NPT THREAD SIZE	PRICE EACH
MS-12	3/4	Call for Pricing
MS-16	1	
MS-20	1¼	
MS-24	1½	
MS-36	2	

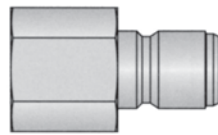

FEMALE PLUG

PART NO.	NPT THREAD SIZE	PRICE EACH
FP-12	3/4	Call for Pricing
FP-16	1	
FP-20	1¼	
FP-24	1½	
FP-36	2	

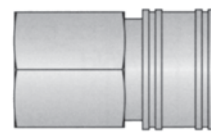

FEMALE SOCKET

PART NO.	NPT THREAD SIZE	PRICE EACH
FS-12	3/4	Call for Pricing
FS-16	1	
FS-20	1¼	
FS-24	1½	
FS-36	2	



HOSE PLUG

For Use With Hose Clamps

PART NO.	HOSE I.D.	PRICE EACH
HP-12*	3/4"	Call for Pricing
HP-16*	1"	

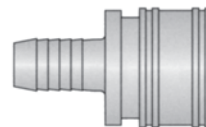

HOSE SOCKET

For Use With Hose Clamps

PART NO.	HOSE I.D.	PRICE EACH
HS-12*	3/4"	Call for Pricing
HS-16*	1"	

Valved Brass Shut-off Couplers

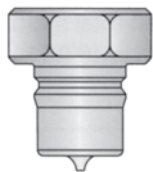

PART NO.	NPT THREAD SIZE	PRICE EACH
HP3434B	3/4	\$14.35
HP11B	1	\$19.40
HP114114B	1¼	\$107.35
HP112112B	1½	\$133.90

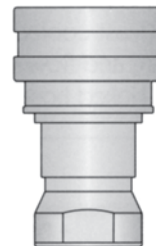

PART NO.	NPT THREAD SIZE	PRICE EACH
HC3434B	3/4	\$35.15
HC11B	1	\$45.20
HC114114B	1¼	\$143.80
HC112112B	1½	\$175.15

CAUTION: SHUT-OFF REDUCES FLOW